

12 10 9

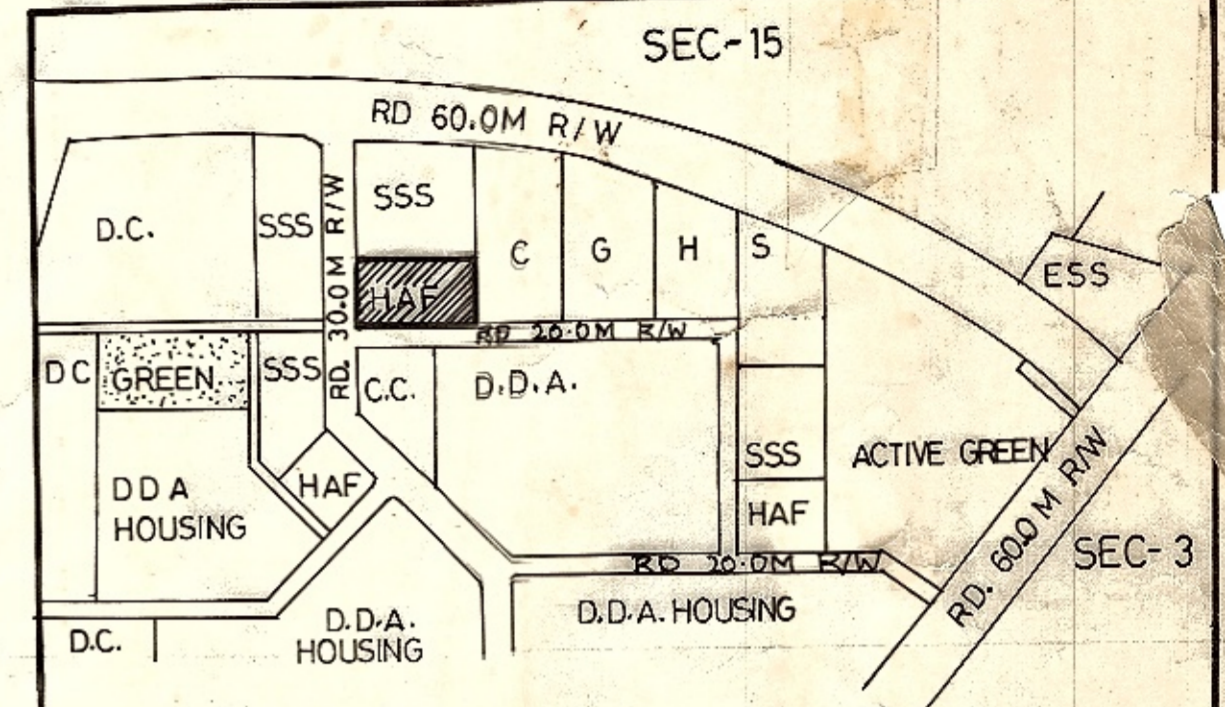
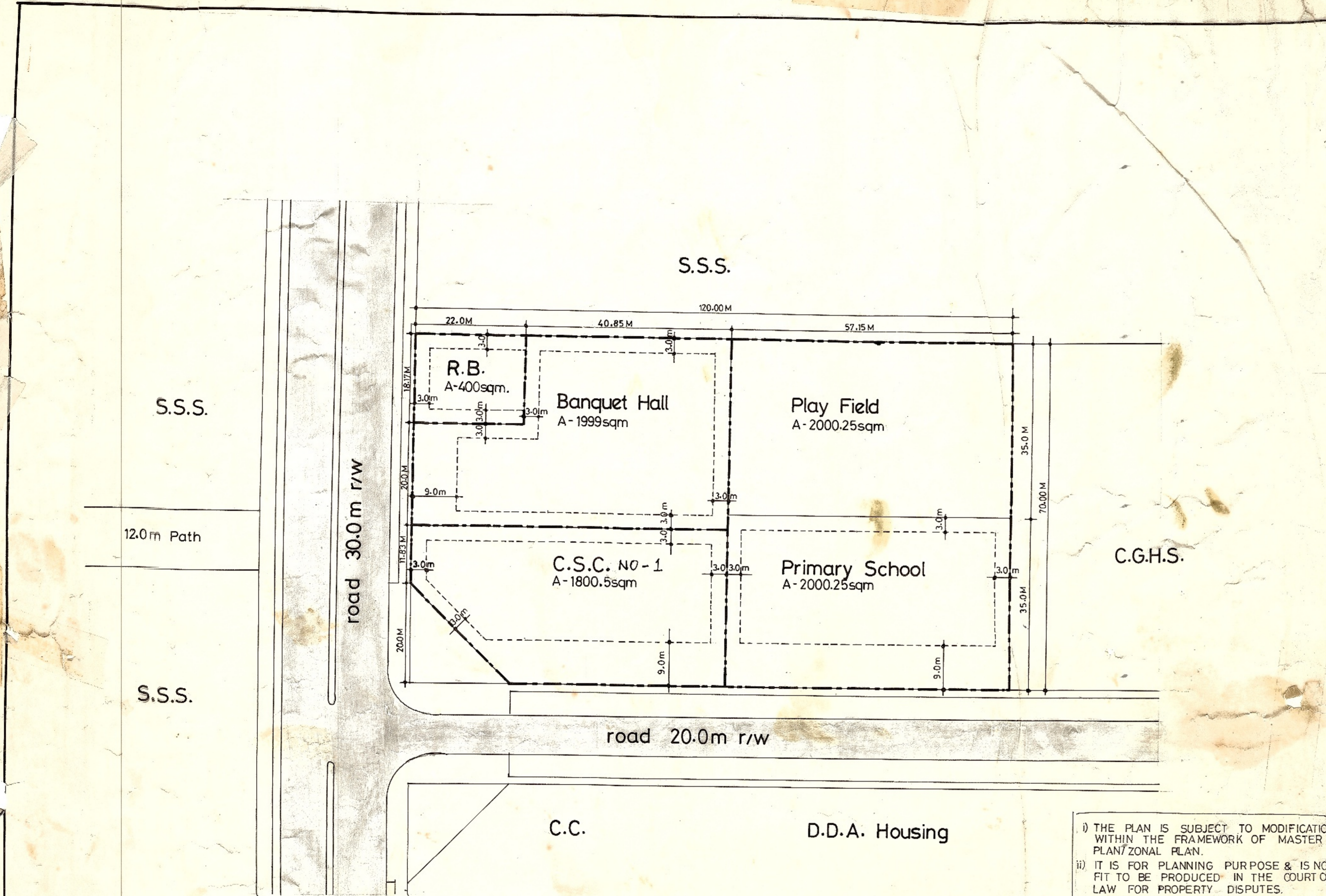

KEY PLAN

Area Statement

TOTAL AREA OF SITE - 8200 SQM.

S.NO.	FACILITY	PROPOSED AREA IN SQM (each plot)	GRD.COV	F.A.R.	MAX. HEIGHT
1	PRIMARY SCHOOL	4000.50	33.00%	100	14m
2	BANQUET HALL	1999.00	35.00%	100	14m
3	C.S.C. + MB + VB	1800.50	40.00%	60	8m
4	RELIGIOUS BLDG.	400.00	33.33%	66.66	8m

TOTAL = 8200.00
OTHER NORMS ARE AS PER MPD 2001

NOTES

- DO NOT SCALE THE DRAWING FOLLOW ONLY THE WRITTEN DIMENSIONS.
- ALL DIMENSIONS ARE IN METRES.
- INCORPORATION OF Ph II IN LAYOUT PLAN APPROVED BY DIR (PLG) ON Pg. 5N IN FILE NO. F 8 (10) 94/DWK/HAF B/Part.

NOTES: APP. BY COMM. (PLG.) ON PAGE 16N IN FILE NO. F 8 (10) 94/DWK/HAF B/PART I DT. 9/4/97

HOUSING AREA FACILITY

HAF (a)

Ph II

- THE PLAN IS SUBJECT TO MODIFICATIONS WITHIN THE FRAMEWORK OF MASTER PLAN/ZONAL PLAN.
- IT IS FOR PLANNING PURPOSE & IS NOT FIT TO BE PRODUCED IN THE COURT OF LAW FOR PROPERTY DISPUTES.
- ALL THE DIMENSIONS & AREA GIVEN IN THE PLAN ARE SUBJECT TO CONFIRMATION OF OWNERSHIP/ALLOTMENT STATUS AND DEMARCATIONS/FEASIBILITY REPORT FROM THE DDA LANDS & ENGINEERING WING RESPECTIVELY.

IDWARKA SUB-CITY (PAPANKALAD)

Proposed Housing Area Facilities Sec-14

		1:500 SCALE	DWK/14(a)/HAF/95/15 DRG. NO.
PLG./MAN	REETA SEHGAL PLG. ASSTT.	JUNE 95 DATE	
T. SINGH ASSTT. DIRECTOR	ANIL BARAI JOINT DIRECTOR	S. SRIVASTAVA DIRECTOR (PLG.)	